

Route 86

Updated: November 2011

Altonah via Upalco to Bridgeland on Route 5, May 14, 1935.

1953 Description:

From Bridgeland on Route 6 northerly, via Upalco and Mt. Emmons to Altonah.

**(*A 2 Copies) Scanned)

1963 Description:

From Route 6 one and one-tenth miles southeast of Bridgeland. **Approved by the Legislature.**

1964 Description:

From SR-6 southeast of Bridgeland northerly via Bridgeland to SR-87.

**(*B) Scanned) Commission Action July 31, 1964.

1964 Description:

From Route 6 one and one-tenth miles southeast of Bridgeland, northerly via Bridgeland, to Route 87. 7/31/64.

1965 Legislature:

(From SR-87 via Upalco to Altamont transferred to SR-87, from Altamont northerly to Altonah transferred to SR-221.

1967 Legislature:

1969 Legislature:

Withdrawn as a State Route by the **1969 Legislature.**

1975 Legislature:

The spur of SR-65 from Henefer northwesterly to SR-3 (I-80N) re-designated SR-86.

1975 Description:

From Henefer on SR-65 westerly to SR-3 (I-80N).

1979 Legislature:

From Route 65 at Henefer westerly to Route 84.

1981 Legislature: Description remains the same.

1983 Legislature: Description remains the same.

1985 Legislature: Description remains the same.

1986 Legislature: Description remains the same.

1987 Legislature: Description remains the same.

1988 Legislature: Description remains the same.

1990 Legislature: Description remains the same.

1992 Legislature: Description remains the same.

1993 Legislature: Description remains the same.

Route 86 Cont.

1994 Legislature: Description remains the same.
1995 Legislature: Description remains the same.
1996 Legislature: Description remains the same.
1997 Legislature: Description remains the same.
1998 Legislature: Description remains the same.
1999 Legislature: Description remains the same.
2000 Legislature: Description remains the same.
2001 Legislature: Description remains the same.
2002 Legislature: Description remains the same.
2003 Legislature: Description remains the same.
2004 Legislature: Description remains the same.
2005 Legislature: Description remains the same.
2006 Legislature: Description remains the same.
2007 Legislature: Description remains the same.
2008 Legislature: Description remains the same.
2011 Legislature: Description remains the same.

* Refers to resolution index page following.

**Refers to Scanned Computer Resolution index on the following page.

Route 86

COUNTY/VOLUME & RESOLUTION NO.

A. Duchesne Co. 1/46	B. Duchesne Co. 1/77	
-----------------------------	-----------------------------	--

DESCRIPTION OF RESOLUTION CHANGE

- (A). Extension - From old alignment of SR-6 in Bridgeland southeasterly to the junction of new SR-6. **(2 Copies)**
- (B). Deletion - From the junction of SR-221 to the junction of SR-87.

Approved Oct. 6, 1962

RECOMMENDED CHANGE IN STATE ROUTE SYSTEM

State Route 6 and 86

Whereas:

The completion of Project F-015-2(4), Duchesne to Bridgeland, will permit the transfer of the existing highway in this area. To maintain continuity in the State Road System, it is deemed necessary that State Route 6 be revised as an interim designation, subject to the approval of the Legislature, to follow the new alignment on new location of Project F-015-2(4), from Engineer Station 103 + 06.2 in Duchesne City, to Engineer Station 650 + 50+-, southeast of Bridgeland.

With the transfer of State Route 6 to this new location, it is recommended that the portion of the old alignment from a point near 4th Street in Duchesne City, to the east city limits be transferred to the jurisdiction of Duchesne City, and that portion of the old alignment, from the Duchesne City east city limits, to a junction with State Route 86 at Bridgeland be transferred to the jurisdiction of Duchesne County.

To provide an adequate connection with the new alignment of State Route 6, it is necessary that State Route 86 be extended from its present junction with the old alignment of State Route 6 in Bridgeland southeasterly, via a newly constructed connection, to a junction with the new location of State Route 6, a distance of approximately 1.1+- mile.

It is further recommended that application be made to the U. S. Department of Commerce, Bureau of Public Roads, requesting the extension of Federal-Aid Secondary Route 252 to follow the proposed extension of State Route 86, and that the portion of old alignment being transferred to the County and City be made local Federal-Aid Secondary Route number 270.

40

And that Federal-Aid Primary Route 15 be transferred to the proposed relocation of State Route 6.

THEREFORE, BE IT RESOLVED, that State Route 6 be revised as an interim designation subject to the approval of the Legislature, to follow the new alignment on new location of Project F-015-2(4) from Duchesne to a point southeast of Bridgeland. And that portion of the old location of State Route 6, from a point near 4th Street in Duchesne to the east city limits, be transferred to the jurisdiction of Duchesne City, and that portion of road from Duchesne City east limits to a junction with State Route 86 at Bridgeland, be transferred to the jurisdiction of Duchesne County.

And, be it further resolved that State Route 86 be extended from its present junction with the old alignment of State Route 6 in Bridgeland southeasterly, via a newly constructed connection, to a junction with the new location of State Route 6 southeast of Bridgeland.

Be it further resolved that application be made to the U. S. Department of Commerce, Bureau of Public Roads, requesting the extension of Federal-Aid Secondary Route 252 to follow the extension of State Route 86, and that the portion of old alignment being transferred to the County and City be made local Federal-Aid Secondary Route number 270. And that Federal-Aid Primary Route 15 be transferred to the new location of State Route 6. These changes will increase the State Route mileage 0.6+- miles, decrease Federal-Aid Primary System mileage 0.6+- miles, and increase Federal-Aid Secondary System mileage 1.1+- miles.

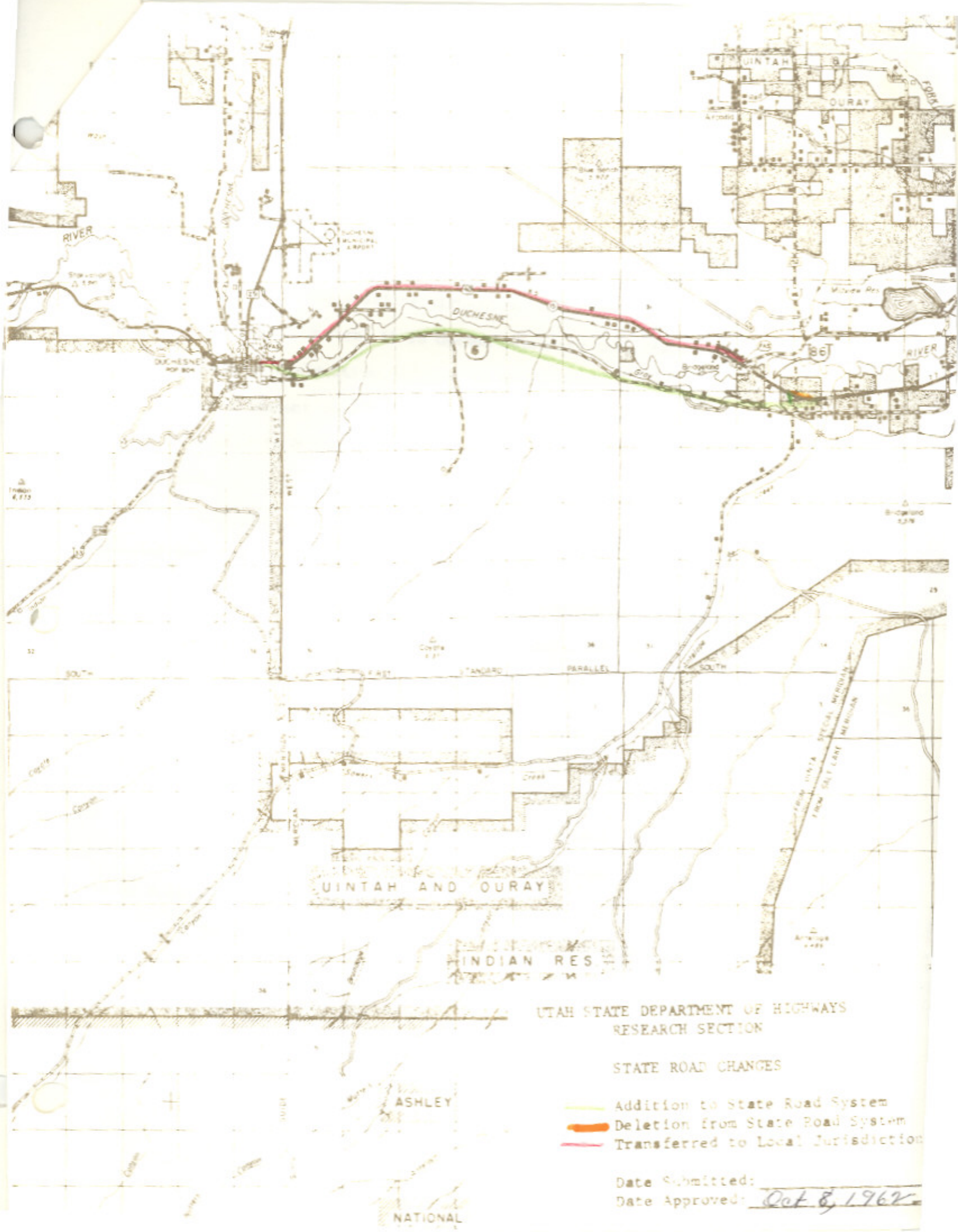

UTAH STATE DEPARTMENT OF HIGHWAYS
RESEARCH SECTION

STATE ROAD CHANGES

- Addition to State Road System
- Deletion from State Road System
- Transferred to Local Jurisdiction

Date Submitted: _____
Date Approved: Oct 8, 1962

U-35-7-87-10
U-86-7-87-2205
U-87-0am
U-134-7-87-1-6
U-221-7-87-2105

RESOLUTION

State Routes 35, 86, 87, 134, 221
35 86 87 134 221

WHEREAS, to maintain continuity in the designation of State Routes in the Blue Bench area, north and east of Duchesne City; and

WHEREAS, Representatives of the Utah State Department of Highways, the governing bodies of Altonah, Bluebell, Mountain Home, Duchesne County and the Area Commissioner of the Utah State Road Commission conducted a field trip over all State Routes in the area; and

WHEREAS, there was mutual agreement of all agencies; and

WHEREAS, there will be no increase in State Route mileage,

NOW THEREFORE, be it resolved as follows:

1. That the State Route designation of 87 will commence at the present junction of State Route 6 and 35 in Duchesne City, traversing that portion of State Route 35 to the present junction of State Routes 35 and 134, thus deleting the designation of State Route 35 for this section of roadway, thence northerly traversing the existing portion of State Route 134 to the present junction of State Routes 134 and 221, south of Mountain Home, thus deleting the designation of State Route 134 for this section of roadway, thence continuing easterly traversing existing State Route 221 to its junction with present State Route 86, south of Altonah, thus deleting the State Route designation of 221, thence east, southeasterly and south, traversing existing State Route 86 to its junction with State Route 87, thus deleting the designation of State Route 86 for this section of roadway, thence east via existing State Route 87 to its junction with State Route 6 southwest of Roosevelt.

2. That with the re-designation of State Route 87, the following interim designations be adopted subject to the approval of the legislature:

State Route 35 - From Wanship on Route 2 via Peoa, Kamas and Tabiona to Route 87.

SR- 35,86,87
134 & 221
77

State Route 86 - From Route 6 southeast of Bridgeland, northerly via Bridgeland to Route 87.

State Route 87 - From Route 6 in Duchesne northerly, thence easterly via Altamont, thence southeasterly via Upalco thence east to Route 6 southwest of Roosevelt.

State Route 221 - From Route 87 in Altamont north to Altonah.

State Route 134 - From Route 87, north via Mountain Home to the Uintah and Ouray Indian Reservation Grazing Land Boundary.

State Route 199 - From Route 87, north to Bluebell, thence west to Route 87 east of Altamont.

3. That application be made to the U. S. Department of Commerce, Bureau of Public Roads, to have the Federal-aid Secondary Route designations changed to follow in continuity with the State Route designations.

Dated this 31st day of July, 1964.

STATE ROAD COMMISSION OF UTAH

Ernest Walsh
Chairman

Fred B. [unclear]
Commissioner

Elmer Strong
Commissioner

Ames K. Bagley
Commissioner

Commissioner

ATTEST:

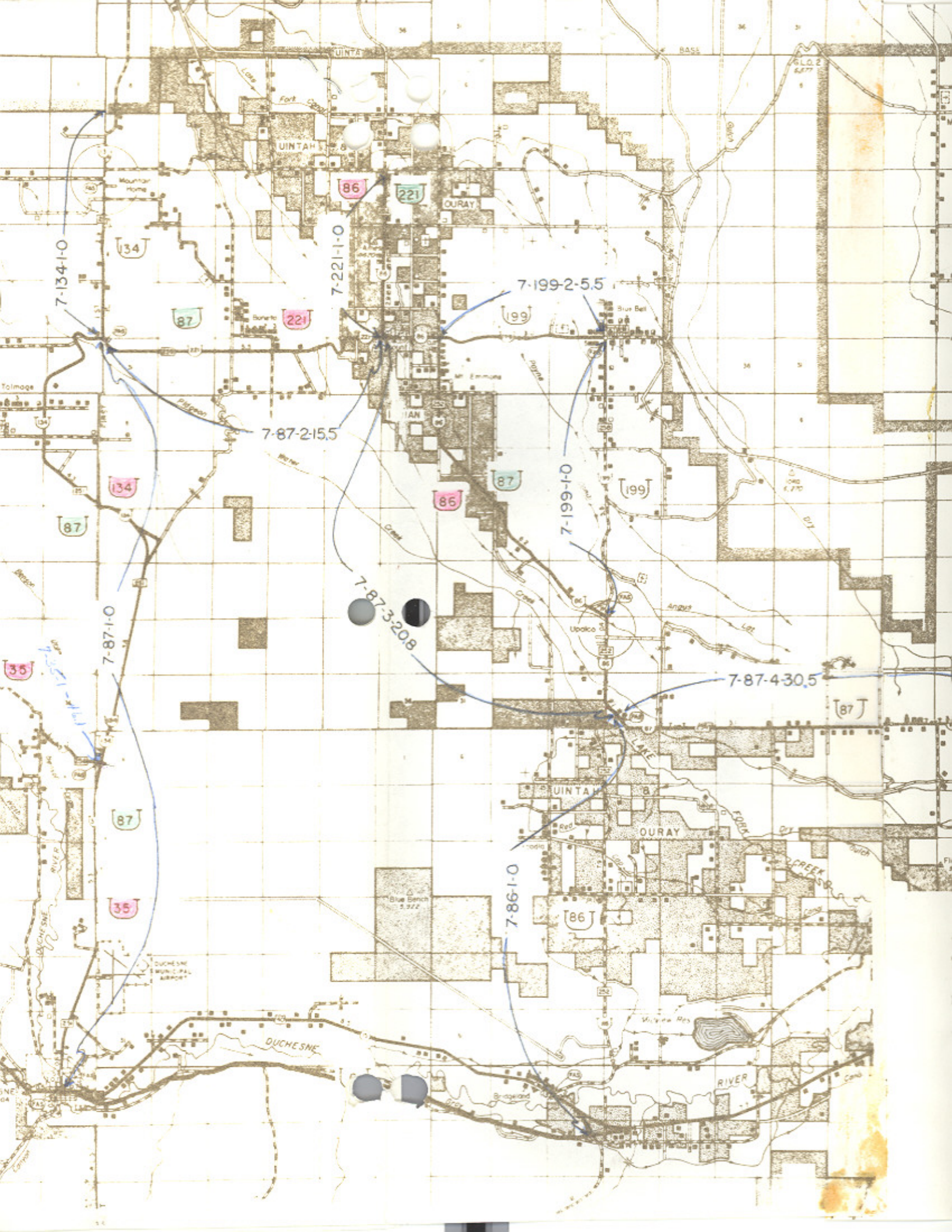

Lawrence [unclear]
Secretary

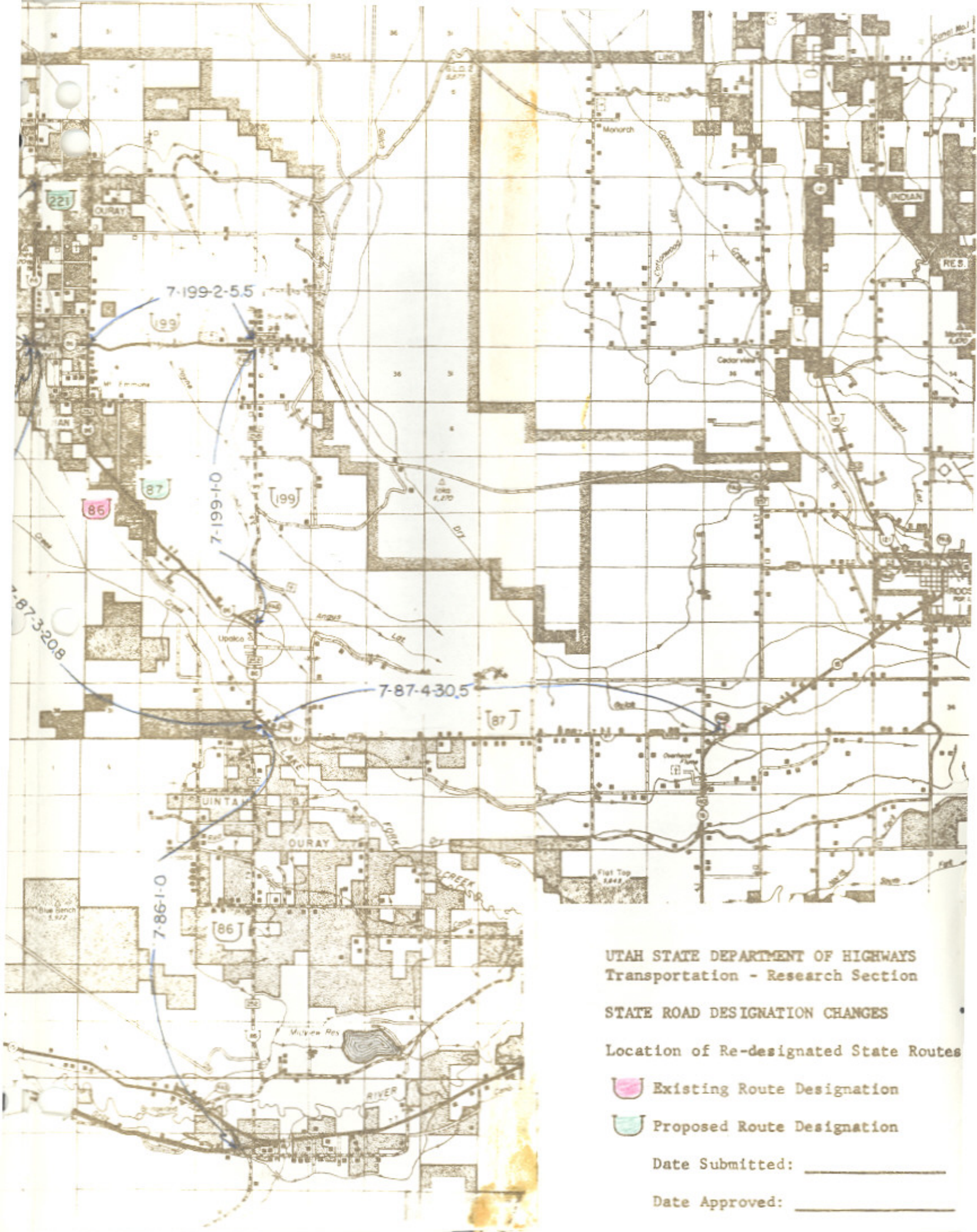



UTAH STATE DEPARTMENT OF HIGHWAYS
 Transportation - Research Section

STATE ROAD DESIGNATION CHANGES
 Location of Re-designated State Routes

-  Existing Route Designation
-  Proposed Route Designation

Date Submitted: _____

Date Approved: _____